

- West End:
- [W1] Improve access at porch entrance.
 - [W2] New glazed screen to provide draught lobby.
 - [W3] New glazed inner doors.
 - [W4] New modern stair down to lower ground floor.
 - [W5] New stairs to first floor gallery.
 - [W6] New tea/coffee bar and table seating.
 - [W7] Existing accessible WC (north porch) and new WCs on south side of church.
 - [W8] New lobby. This lobby can be secured to enable independent use of the first floor accommodation, separate from the church.
 - [W9] Lift to all floors.
 - [W10] Cleaner's store.
 - [W11] Dumb-waiter to/from first floor kitchen.
 - [W12] New storage cupboards for tables and chairs.

- East End:
- [E1] New dais, lower and smaller than the existing dais.
 - [E2] Indicative location of new access ramp/platform lift.
 - [E3] Organ console to be moveable.
 - [E4] Existing side chapel screens removed.
 - [E5] New stairs to gallery above.
 - [E6] Improvements to secondary access to lower ground floor.

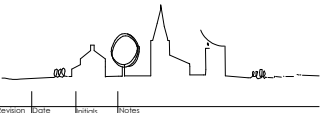
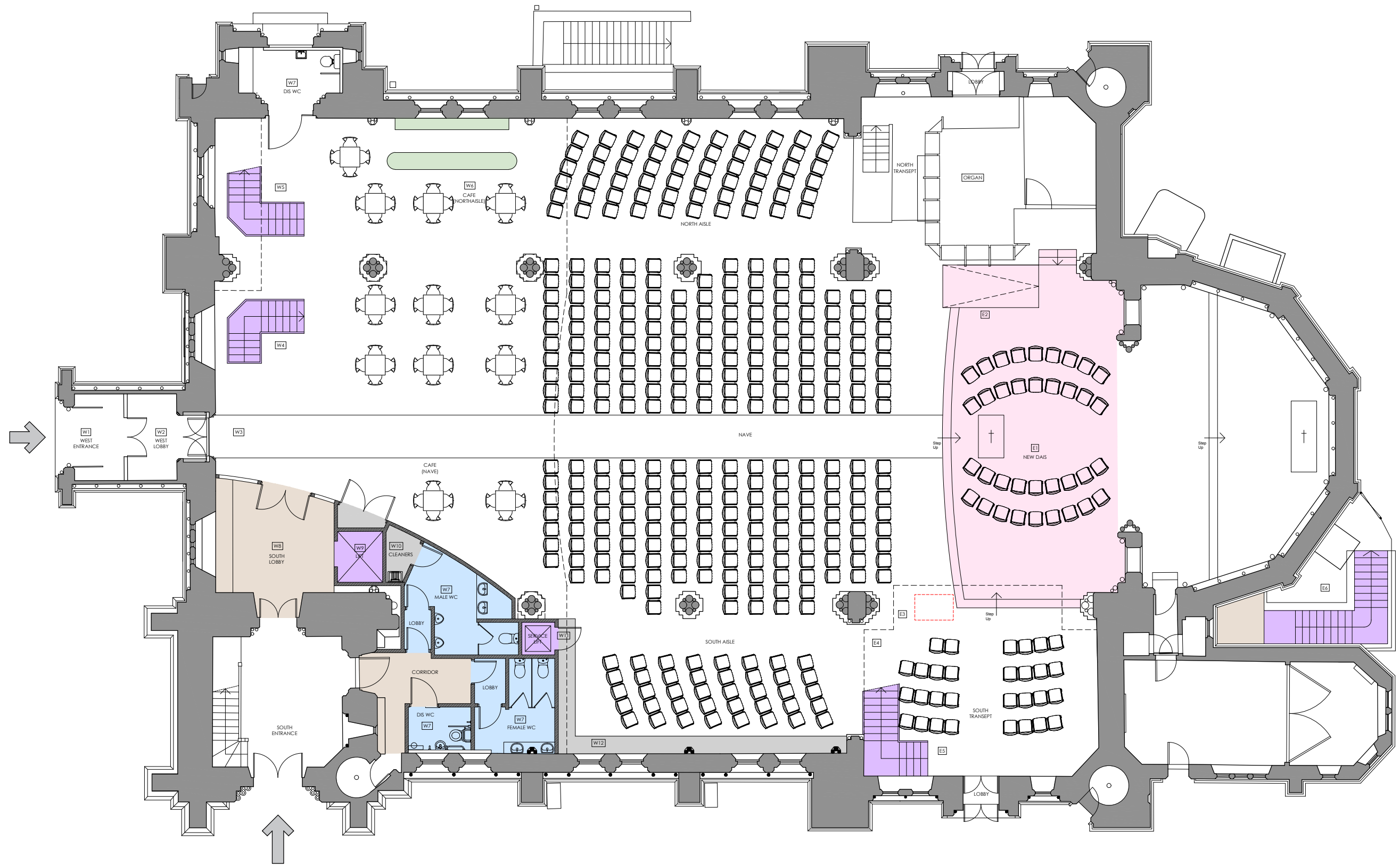

CLIFTON
Christ Church

Proposed Ground Floor
Plan

PRELIMINARY

benjamin + beauchamp
architecture design conservation
the borough studios, the borough,
wedmore, somerset BS28 4EB
T 01934 713313 F 01934 713314

Scale
KL 30/09/15 1:50 at A0
Drawing No: 0311.SK.023